

HONKA DELIVERY CONTENT

WALL STRUCTURES

LOG FRAME

General notes

- height of side walls: according to the master plan
- layers of logs :according to the master plan
- roof slope : according to the master plan 15 deg.
- log to choose : Laminated 112, 134, 182 ,204 ,242 , 270 mm. Round Logs 170,190,210,230 mm
- Electric holes according to Honka standard drilling designed in log wall drawings, unless otherwise specified
- posts for the terraces and inside the house: with screw jacks on the bottom



ACCESSORIES FOR THE LOG FRAME

- metal collars to cover screw-legs according to log type (for internal and outer columns)
- factory installed sealing between Laminated logs and sealing strip in the corners / Round logs polypropylene strip.
 - T-battens for doors and windows, ready to install
 - T-battens for brick / block walls, ready to install
 - rolls of sealing for T-battens
 - wooden dowels, ready to install
 - tightening bolts for the external corners as in the wall diagrams
 - steel pipes, adjusting bolts and other necessary ironmongers for log frame
- polythene strip between the log frame and the foundation
- Glue beams pre-cut according masterplan

GABLE EAVES, LOG GABLE ENDS OR STUDS DEPENDS MODEL

- overhang supported by log beams
 - design according master plans and technical detail drawings
 - with decorative ends

LOG OPENINGS

- according to the master plan drawing
- design according to master plans and technical detail drawings

LOG CAPPINGS

- log cappings (for internal beams and also for external beams on the terraces and balconies except the log endings)
 - internal parts of terraces

STUDWORK PARTITION WALL

- studwork (timber frame, top and bottom sills) 41*70 c/c 600mm
- Surface Planed FXL 24 x 279
- strips/ Mouldings covering the settling space



Log panels

Honka supplies log panels which harmonizes light partition walls, for example, with the solid log walls of the house.

ROOF STRUCTURE

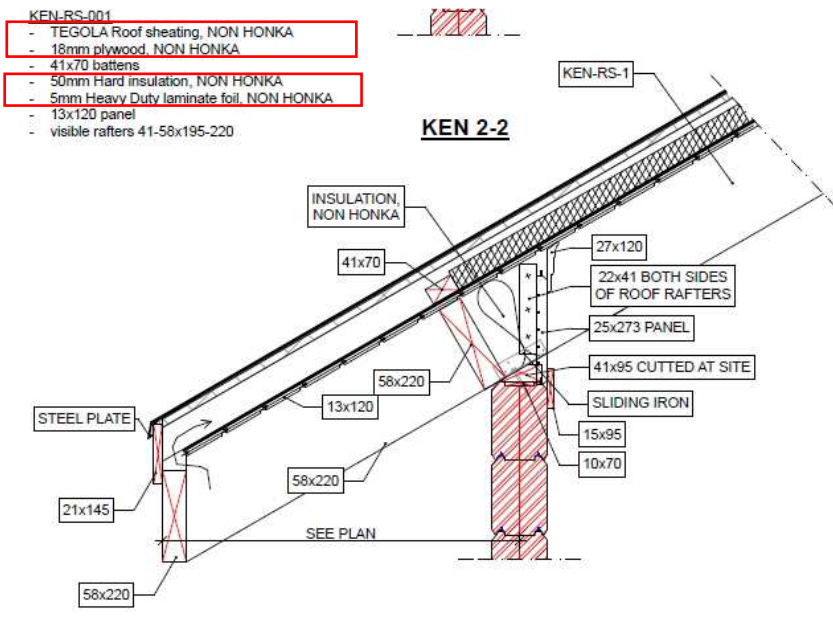

FLOOR CONSTRUCTIONS

- **Ground floor construction NON Honka**
- Terrace floor, Pressure treated boards according construction drawings
- Exterior railings, Type MARS

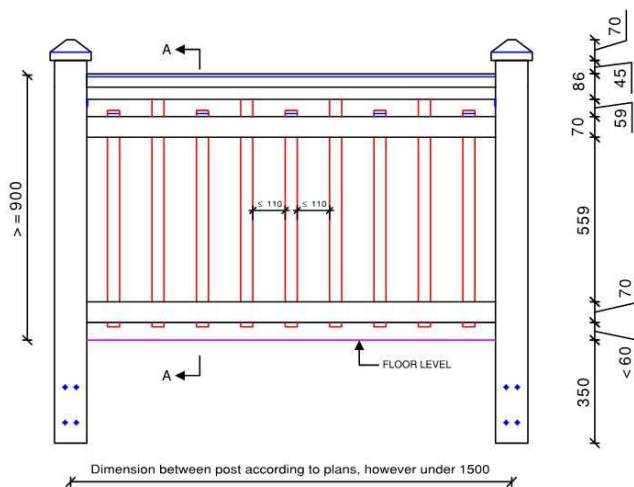

DOORS AND WINDOWS

EXTERIOR DOORS

- KUP WOODEN doors
- open outwards or inwards according master plan (hardwood threshold)
- vertical pattern
 - patterned panelling on both sides, pre-assembled with double sealing, treated with transparent protective coating
 - frames treated with transparent protective coating, depth of the frame 94 mm
 - glue-laminated structure fitted with polyurethane insulation sandwiched between two plywood sheets
 - glass doors have triple glazing (filled with Argon gas), detachable lattice on the exterior face
 - standard lock, lock cylinders and fittings ready for assembly
 - factory-made fittings (lock body / hinges)

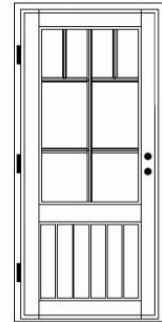

KUP 9x19-6 PP

SLIDING EXTERIOR DOORS (According master plan)



INTERIOR DOORS

Type VOP – solid pine wood interior door (manufacturer Artopine Oy)

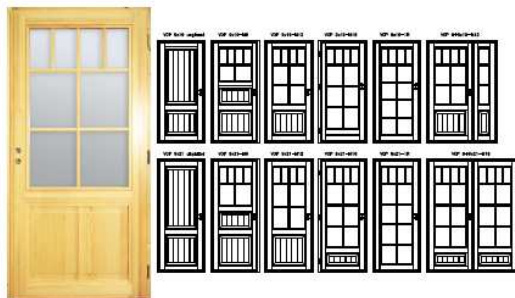

- VOP doors
 - interior pine panel door, varnished (colourless) panel leaves laminated 3-layer structure
 - factory-made fittings (lock cases / striking plates / hinges) included
 - detachable oak thresholds
 - glass doors have lattice on the opening side
 - door frames treated with transparent protective coating, depth of the frame 94 mm
- Brass fittings

WINDOWS , tilt & turn

- lattice type: without lattice
- DK-windows Wood, double glass
 - factory-made fittings (locks / closing mechanism / hinges / keeps / stay fasteners / escutcheon plates / handles) included
 - treated with for both outside & inside casement with rubber sealing
 - DIN approved single-framed tilt and turn window, double selective glass (4mm) insulated with Argon gas, U-value 1,7 W/m²K,
 - Mosquito nets for windows 6x12 and smaller/Aluminium frame
- window sills

SPECIAL WINDOWS (according master plan)

- fixed windows **MEK Wood**
 - double selective glass (4mm) insulated with Argon gas, U-value 1,4 W/m²K, treated with clear protective coating
- Clear protective coating for inside and outside

ACCESSORIES FOR DOORS AND WINDOWS

- Honka-design interior and exterior architraves ready for assembly
 - pre-assembled spreader mouldings / strips according to the thickness of the logs with screws
 - covering strips for frame to frame joints
 - Honka-design decoration pieces ready for assembly
 - architraves for the brick / block walls (pre-measured)
 - plastic fittings for the ends of the external window sill, when the spreader moulding is over 44 mm
 - pre-shaped fitting wedges for window and door elements
 - installation screws and key for the frames
- interior architrave grade: EXPORT
- exterior architrave type: CLASSIC



Spere
The c
mouli
pieces
Wind
profe

Honka Brass
(brass colour anodized aluminium)



Hoppe New York 1810H42 FIF3

Inward opening, single-casement timber tilt & turn window
Triple glazed (with low-E coating) woodcase, also double glazed option possible (DK 2K)
Casement can be turned open sideways and tilt for ventilation

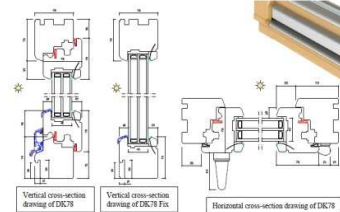
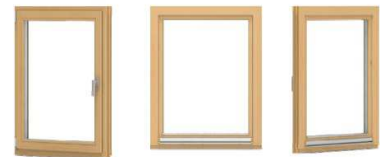

FITTINGS FOR DOORS AND WINDOWS

- fitting type: Honka Brass for exterior door, interior doors and windows

ROOF LIGHTS

- VELUX GDL 780 x 1180, pine all around, with flash and electrical openable system

PACKING AND TRANSPORTATION

PACKING

- plastic package
 - all materials included in the delivery are packed in a transportation packaging that provides protection from sun and rain
 - doors, windows and the majority of the timber parts for interior cladding are packed in tight stretch-film wrapping

TRANSPORTATION

- FCA , Karstula Factory, Finland

DRAWINGS AND ERECTION INSTRUCTIONS

- master plans (working drawings): plans, sectional and elevation drawings
- dimensional drawing for foundation
- structural drawings and joint details for supporting wooden parts
- log frame wall diagrams (supplied in a log bundle number 1)
- material lists (supplied in a timber bundle)

GENERAL

- general notes
 - The scope of this delivery does not include erection.
 - Timber parts supplied are of untreated wood; kiln-dried, numbered, mainly planed all over and cut to size; cut at the discretion of the supplier for rooms of over 4 metres.
 - All pressure treated timber parts are delivered as run-of-mill lengths; pressure treated joists as unplaned.
 - Dimensions and profiles of the timber parts are standard Honka dimensions.
 - Stress graded finger- and circular-joints are permitted in the logs and timber parts.
 - Honkarakenne Oyj reserves the right to make technical changes to the house during structural design if necessary, without that the object of the purchase will change substantially.